

CMS1600

Standard-A Receptacle

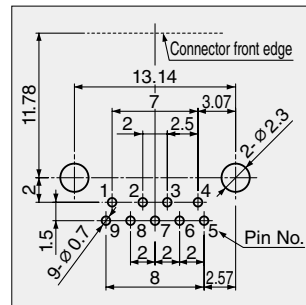

CMS1600-010020

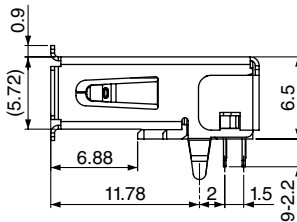
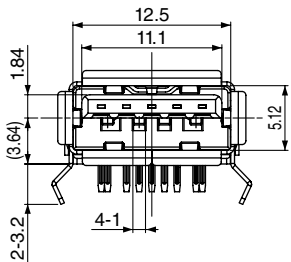
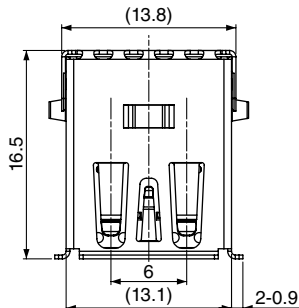

**Hole Layout
(Bottom View)**

定格 Rated	Power Line : 1.8A 30V AC Signal Line : 0.25A 30V AC
接触抵抗 Contact Resistance	<ul style="list-style-type: none"> • Power-Ground Initial : 30mΩ max. • Other Contacts Initial : 50mΩ max.
絶縁抵抗 Insulation Resistance	100MΩ min. at 100V DC
耐電圧 Withstanding Voltage	100V AC/1 minute
挿抜力 Insertion & Withdrawal Force	Insertion Force Initial : 35N max. Withdrawal Force Initial : 10N min.